

## Prime Restaurant Space for Lease

22323 SHERMAN WAY

**Major Center!!!**



**Do NOT Disturb Tenant!!**

**LOCATION:**

22323 Sherman Way  
West Hills, Ca 91303

**SIZE:**

**Unit 14** – 1,080 +/- square feet  
**Unit 21-25** – 4,521 +/- square feet  
**Unit 27** – 1,140 +/- square feet

**RENTAL RATE:**

\$1.75 - \$2.50 per square foot, NNN (\$0.59)

**OCCUPANCY:**

30 Days

**PARKING:**

Excellent front parking

**COMMENTS:**

- \* Adjacent to Ralph's Supermarket & Athletic Society Gym
- \* High traffic count of over 30,000 +/- cars per day
- \* Prominent signage on building & monument sign
- \* Walking distance to many area amenities
- \* Just west of Topanga Canyon Boulevard

## FOR MORE INFORMATION OR A TOUR, PLEASE CONTACT:

**Richard L. Paley**

[richard@paleycommercial.com](mailto:richard@paleycommercial.com)

DRE: 00966353

**Howard Bass**

[howard@paleycommercial.com](mailto:howard@paleycommercial.com)

DRE: 00940993

19507 Ventura Boulevard, Tarzana, Ca 91356 ~ Phone (818) 343-3000 ~ Fax (818) 343-3311

[www.paleycommercial.com](http://www.paleycommercial.com)



Shoup Avenue

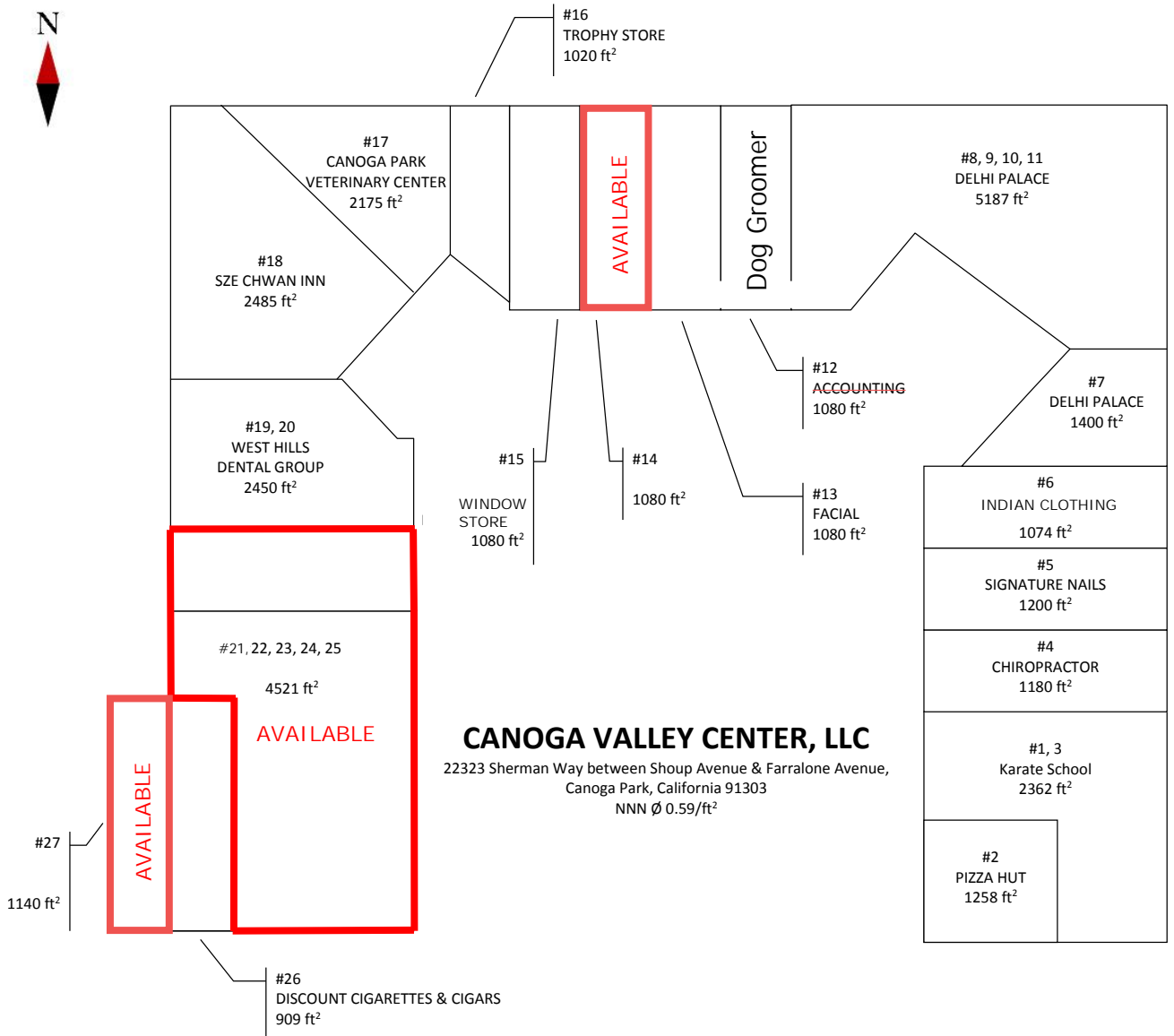

Sherman Way